

HOW TO TIE A TREFOIL KNOT IN THE FRY BUILDING

Scott Hamper (15/01/2020)

Caveat lector: I'm going to use the lift, exit and reenter the building and use a short stretch of corridor twice, once along each wall.

1. How to tie a trefoil knot in any "sufficiently large" building.

Consider a building with five floors $0^{\text{th}}, 1^{\text{st}}, 2^{\text{nd}}, 3^{\text{rd}}, 4^{\text{th}}$ (and maybe others) and five staircases A, B, C, D, E along a corridor (or something topologically equivalent) that can access all five of $0^{\text{th}}, 1^{\text{st}}, 2^{\text{nd}}, 3^{\text{rd}}, 4^{\text{th}}$ floor (see black part of Figure 1).

Here's how to tie a trefoil knot.

Start at staircase B on 2^{nd} floor and go up to 4^{th} .

Go to E and down to 1^{st} .

Go to C and up to 3^{rd} .

Go to A and down to 0^{th} .

Go to D and up to 2^{nd} .

Walk along to where you started at B.

(See blue part of Figure 1.)

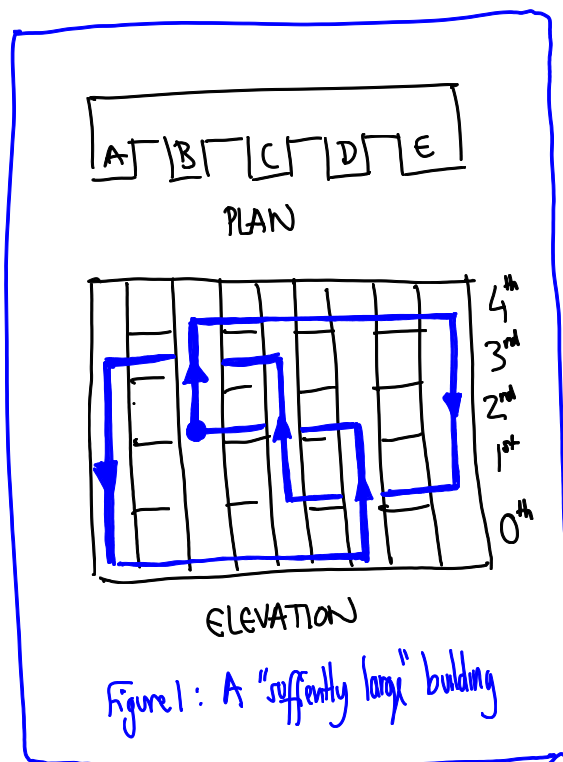

Figure 1: A "sufficiently large" building

Alas! The Fry building is not "sufficiently big"! While there are five floors (LG, G, 1, 2, 2A) LG is only accessible in the south east wing and 2A is only accessible in the north west wing. We therefore need to modify the above method.

2. How to modify the approach for the Fry Building

We adopt the strategy of section 1 with roughly the following floor and staircases (see Figures 2&3)

- 0th = "outside" A = North (N)
- 1st = LG B = West (W)
- 2nd = G C = Helix (H), Basement (B)
- 3rd = 1 D = Lift (L)
- 4th = 2 E = South (S), East (E), Theatre (T)

Here's how it's done (see figure 4).

Start at West staircase on G and go up to 2.

Go through the common room to the East Lift and down to LG.

Pass the vending machine, go up the small set of steps to the reception area and up the Helix staircase to 1.

Go to the North staircase and down to G, then exit the building by the accessible door, walk down University Rd, under the bridge to the other geography building. Reenter the building through the revolving door.

Go to the South staircase and up to G, then go to the East staircase and up to 1, then go to lecture theatre G.10 and exit on G, staying on the right, from here you can walk back to the West staircase, where you began.

